

NEW FOR 2013

tough security made easy

Sensor Clamp

Protects the phone's SIM card and battery from theft.

The Sensor Clamp adds a layer of protection to your merchandise and easily fits through the zip tie slot of InVue's sensors.



Adjustable Steel Arms
Adjustable width to protect a variety of smartphones.



Compatible with Series 940 and Series 1000.

unit dimensions

HC7501

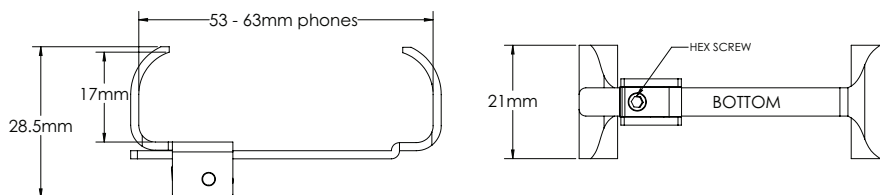

HC7504

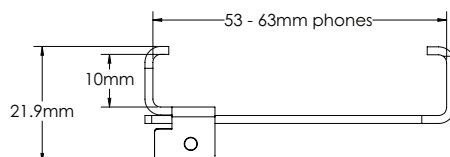

HC7505

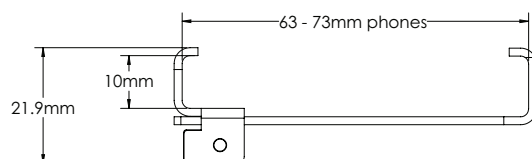

HC7503

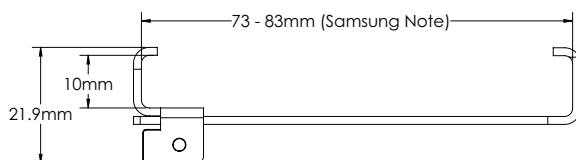

product ordering

ORDER CODE	DESCRIPTION	EXTERNAL DIM. (H x W x D)	CARTON QTY.	CARTON WT.
HC7501-W HC7501-B	Sensor Clamp 63W Thick (53mm - 63 mm) - White Sensor Clamp 63W Thick (53mm - 63 mm) - Black	5.0" H x 4.6" W x 0.85" D (12.7cm H x 11.7cm W x 2.2cm D)	1	0.1 lbs (0.04 kg)
HC7504-W HC7504-B	Sensor Clamp 63W Thin (53mm - 63 mm) - White Sensor Clamp 63W Thin (53mm - 63 mm) - Black	5.0" H x 4.6" W x 0.85" D (12.7cm H x 11.7cm W x 2.2cm D)	1	0.1 lbs (0.04 kg)
HC7505-W HC7505-B	Sensor Clamp 73W Thin (63mm - 73 mm) - White Sensor Clamp 73W Thin (63mm - 73 mm) - Black	5.0" H x 4.6" W x 0.85" D (12.7cm H x 11.7cm W x 2.2cm D)	1	0.1 lbs (0.04 kg)
HC7503-W HC7503-B	Sensor Clamp XL Thin (73mm - 83 mm) - White Sensor Clamp XL Thin (73mm - 83 mm) - Black	5.0" H x 4.6" W x 0.85" D (12.7cm H x 11.7cm W x 2.2cm D)	1	0.1 lbs (0.04 kg)

CORPORATE OFFICE // North America // 704.752.6513 // 888.55.INVUE

EUROPEAN OFFICE // The Netherlands // +31.23.8900150

ASIAN OFFICE // Singapore // +65.6766.4844

LATIN AMERICA OFFICE // Mexico // +52.55.90003957

©2012 InVue Security Products. No endorsement of InVue products has been made by any of the manufacturers of the products shown. Product is sold pursuant to InVue's warranty which can be found at www.invuesecurity.com/english/warranty.html